

ADVANTAGES

- Easy Maintenance Operations
- Energy saving
- Excellent Chemical Resistance
- Robust Construction

FEATURES

- External Mechanical Seal available with different material combinations
- Tmax exercise: PP75°C - PVDF 95°C - PVC 50°C
- Connections:
 - Threaded
 - Flanged

APPLICATIONS FIELDS

- Acid and alkaline solutions with minimal suspended particles
- Electroplating, Chemical, PCB Industry

	Flow Rate max (l/min.)	Head max (m)	Motor	
			(kw)	(HZ)
03A1	380	20	1,5	50/60
03A2	470	20	2,2	50/60
03A3	600	20	4,0	50/60
03B1	550	24	3,0	50/60
03B2	650	24	4,0	50/60
03B3	700	28	5,5	50/60

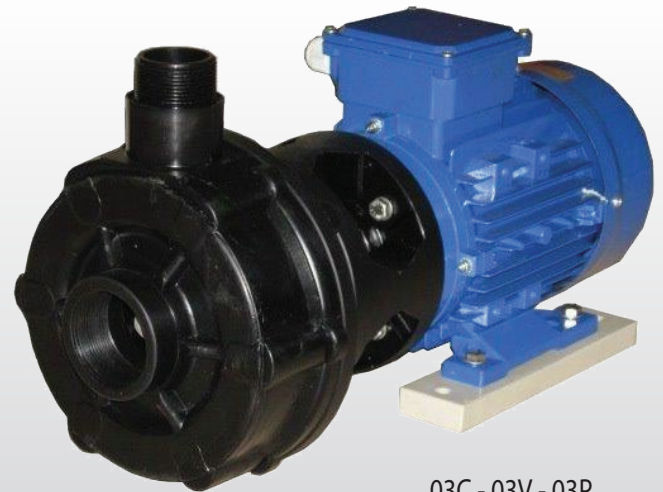

03C - 03V - 03P

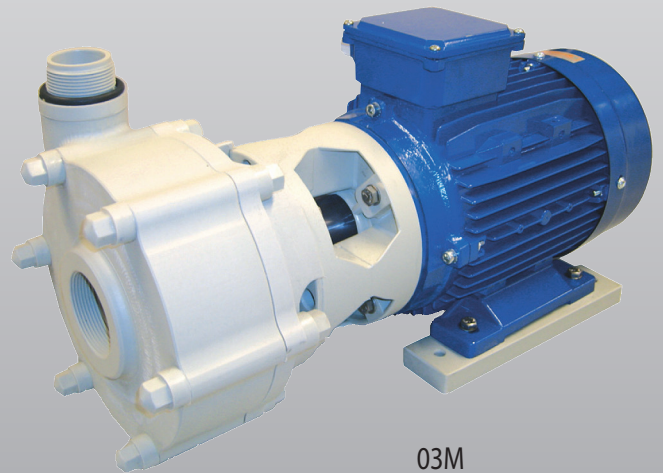

03M

PUMP IDENTIFICATION

Model	Pump body	Shaft	Mechanical Seal / Rotating-Static	Oring	Motor/Rpm	Optional
03A1 03A2 03A3 03B1 03B2 03B3	P = PP molded M = PP solid C = PVC V = PVDF	X = SS 316 T = Titanium H = Hastelloy	1 = PTFE/Ceramic 4 = Sic/Carbon 5 = Sic/Sic 6 = Carbon/Ceramic 7 = Sic/Sic with anti-rotation pin	E = EPDM V = Viton	A = 50Hz/2800 B = 60Hz/3400	F = Flange
03B2	P	H	6	E	A	F

Performance Curve 50 Hz - Rpm 2800

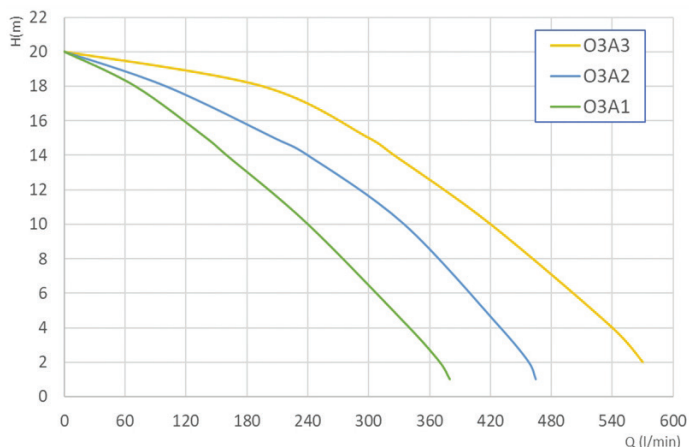

Curves referred to water = 20°C

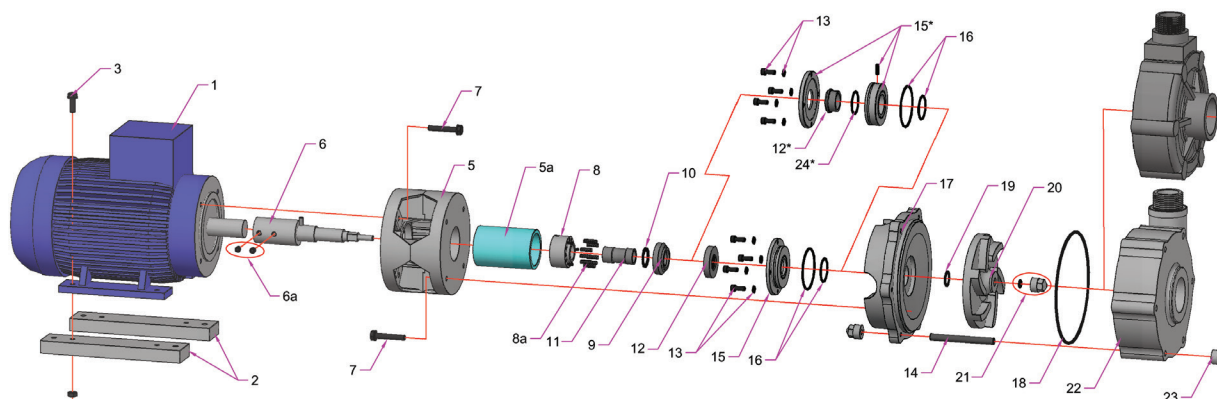
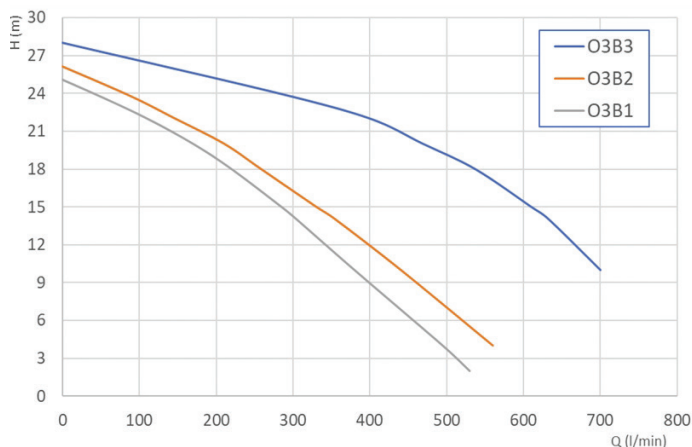

- | | | | |
|----------------------|--|--|---|
| 1 Motor | 8 Mechanical seal body | 14 Pump housing tie rod | 20 Impeller |
| 2 PP motor support | 8a Spring mechanical seal body | 15 Static ring housing | 21 Ogive kit |
| 3 Motor fixing screw | 9 Rotating ring | 15* Static ring with anti rotation pin housing | 22 Pump housing |
| 5 Bracket | 10 O-Ring | 16 Static ring housing O-Ring | 23 Pump housing nut |
| 5a Bracket | 11 Shaft cover | 17 Pump housing flange | 24* Static ring with anti rotation pin O-Ring |
| 6 Shaft | 12 Stating ring with anti rotation pin | 18 Pump housing O-Ring | |
| 6a Grub screw | 12* Stating ring Long Tail | 19 Impeller O-Ring | |
| 7 Bracket screws | 13 Mechanical seal flange screw | | |

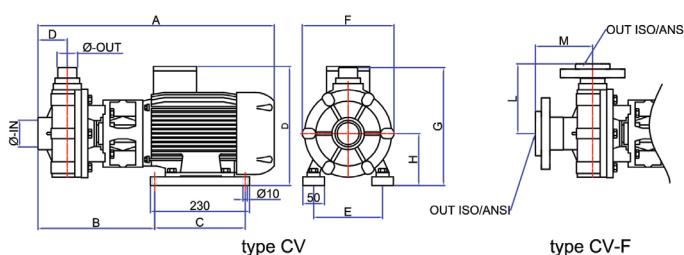
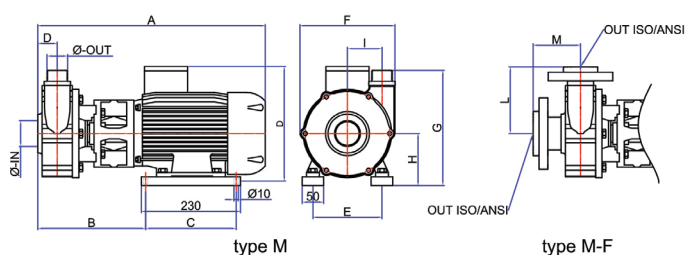

Pump Dimension serie "O3"													
MOD.		A	B	C	D	E	F	G	H	I	L	M	Ø-IN Ø-OUT
O3A1	M	482	233	200	45	140	223	233	110	81	154	110	2" 1 1/2"
	CV	502	253		68			253			166	133	
O3A2	M	509	245	200	45	140	223	245	110	81	154	110	2" 1 1/2"
	CV	529	265		68			265			166	133	
O3A3	M	534	260	200	45	160	223	260	120	81	154	110	2" 1 1/2"
	CV	554	280		68			280			166	133	
O3B1	M	534	260	200	45	160	223	260	120	81	154	110	2" 1 1/2"
	CV	554	280		68			280			166	133	
O3B2	M	534	260	200	45	160	223	260	120	81	154	110	2" 1 1/2"
	CV	554	280		68			280			166	133	
O3B3	M	545	260	200	45	190	223	260	132	81	154	110	2" 1 1/2"
	CV	565	280		68			280			166	133	

LAFONTE.EU may modify data any time, without notice, in order to get product enhancement