

POMPE A MEMBRANA

DIAPHRAGM PUMPS

BX50-BX51



PVDF

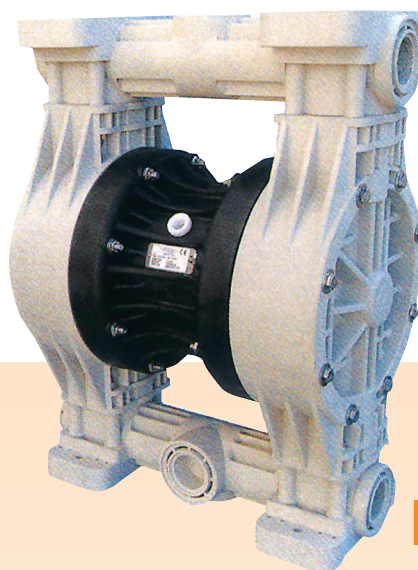

PP

DATI TECNICI

TECNICAL DATA

BX50

BX51

Attacchi entrata uscita * <i>Inlet outlet*</i>	2" F GAS	G3" F GAS
Attacco aria <i>Air connection</i>	G1 / 2" F	G3 / 4" F
Capacità autoadescamento** <i>Max. self-priming capacity**</i>	4 m	5 m
Portata Max. ** <i>Max. flow rate**</i>	650 l/min	900 l/min
Prevalenza Max.** <i>Total head**</i>	70 m	70 m
Pressione Max.alimentazione aria <i>Max. air supply pressure</i>	7 bar	7 bar
Massimo diametro passaggio ammisibile solidi <i>Max. diameter of passing solids (spherical particles)</i>	8 mm	10 mm

Mod. <i>Mod.</i>	Materiali di costruzione <i>Construction materials</i>	Peso <i>Weight</i>	Max. operating temp. <i>Max. operating temp.</i>
BX50	PP	12 Kg	60°C
	PVDF	14 Kg	95°C
BX51	PP	16 Kg	60°C
	PVDF	20 Kg	95°C

* Attacchi flange a richiesta
Flanged attacks on request

** Dipende dai materiali costruttivi
Depends on used material

BX50 POMPE A MEMBRANA DIAPHRAGM PUMPS BX51

DIMENSIONI DIMENSIONS

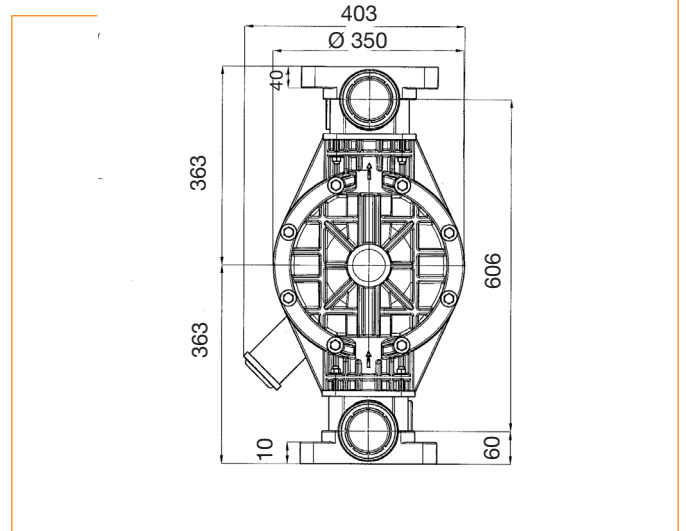
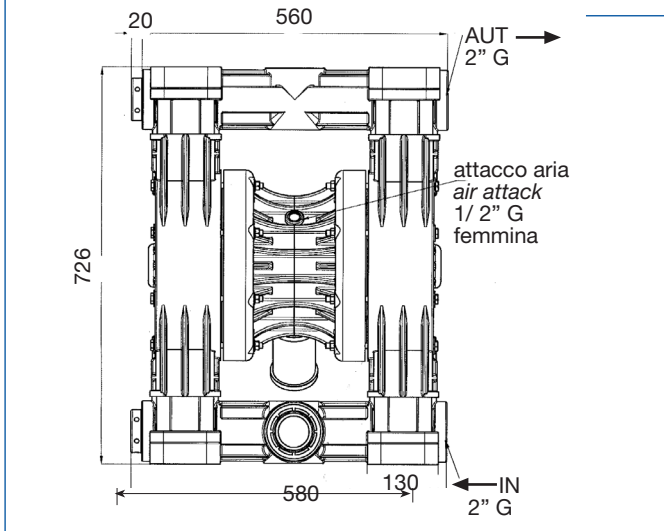

BX50

CURVE PERFORMANCE

BX51

■ Pressione aria
Air supply pressure
■ Consumo aria
Air consumption NI/min

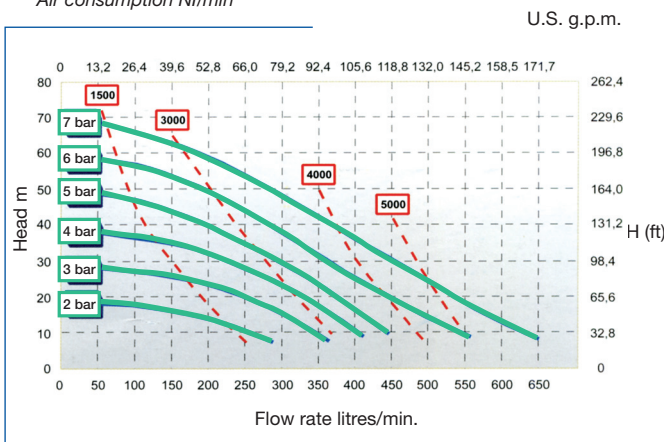

■ Pressione aria
Air supply pressure
■ Consumo aria
Air consumption NI/min



TABELLA MATERIALI

PUMP MATERIALS

Modello <i>Model</i>	Corpo pompa <i>Pump body</i>	membrana lato aria <i>Membrane air side</i>	Sfere <i>Balls</i>	Membrana PTFE <i>Membrane PTFE</i>	Sedi sfere <i>Balls housing</i>	O-ring <i>O-ring</i>	Collettore sdoppiato <i>Twin manifold</i>
BX50 BX51	P = PP F = PVDF AL = Alluminio <i>Alluminium</i> A = AISI 316 <i>ss 316</i>	N = NBR D = EPDM H = Hytrel M = Santoprene	T = PTFE A = AISI 316 <i>ss 316</i> C = Ceramica <i>Ceramic</i> G = Vetro <i>Glass</i> N = NBR D = EPDM	T = Quando richiesto T = <i>When required</i>	P = PP F = PVDF A = AISI 316 <i>ss 316</i> I = HMW R = PPS-V	D = EPDM V = Viton S = Silicone N = NBR T = PTFE	X = Quando richiesto X = <i>When required</i>

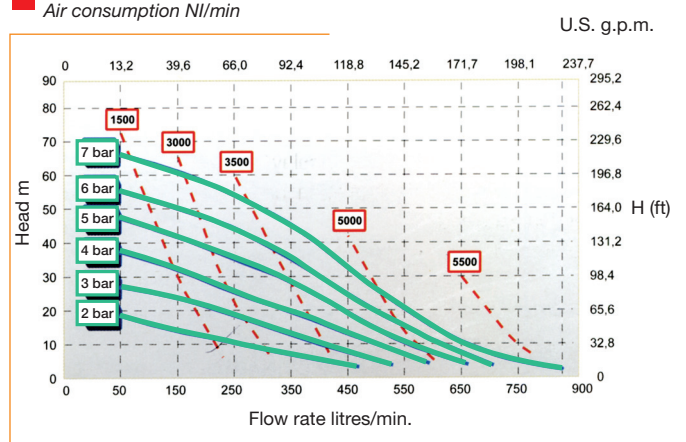

P.le Cocchi, 6 - 21040 Veduggio (VA) Italy
 Tel. +39 0332 402168 Fax +39 0332 402169
 e-mail: info@lafontesrl.it - www.lafonte.eu